

TOTAL -- AC.

NOTES: LOCATIONS ARE APPROXIMATE. FIELD CONDITIONS MAY VARY.

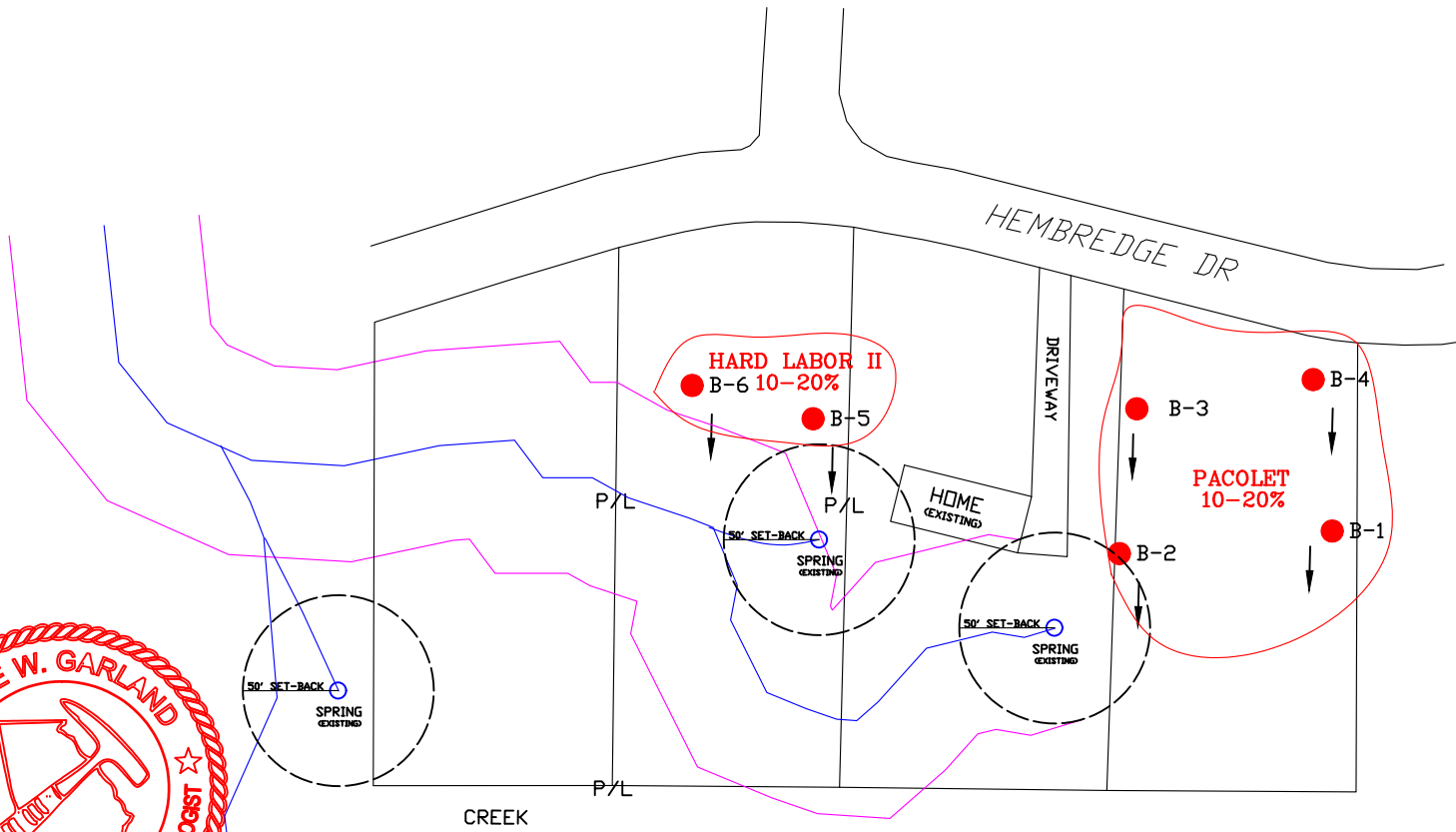

# GARLAND

ENVIRONMENTAL & GEOLOGICAL SOLUTIONS, LLC.

2219 BRUSHY TOP ROAD  
ELLIJAY, GA 30540  
(706) 844-6753  
lwgardland@garlandgeological.com

LEVEL 3 SOIL SURVEY  
255 & 301 HEMBREDGE DRIVE  
CANTON, GA

SCALE 1" = 100'



### LEGEND

- B-1 = Boring Location
- = Slope Direction
- PACOLET = Soil Series
- 10-20% = And % Slope

TOTAL 2 AC.

NOTES: LOCATIONS ARE APPROXIMATE. FIELD CONDITIONS MAY VARY.

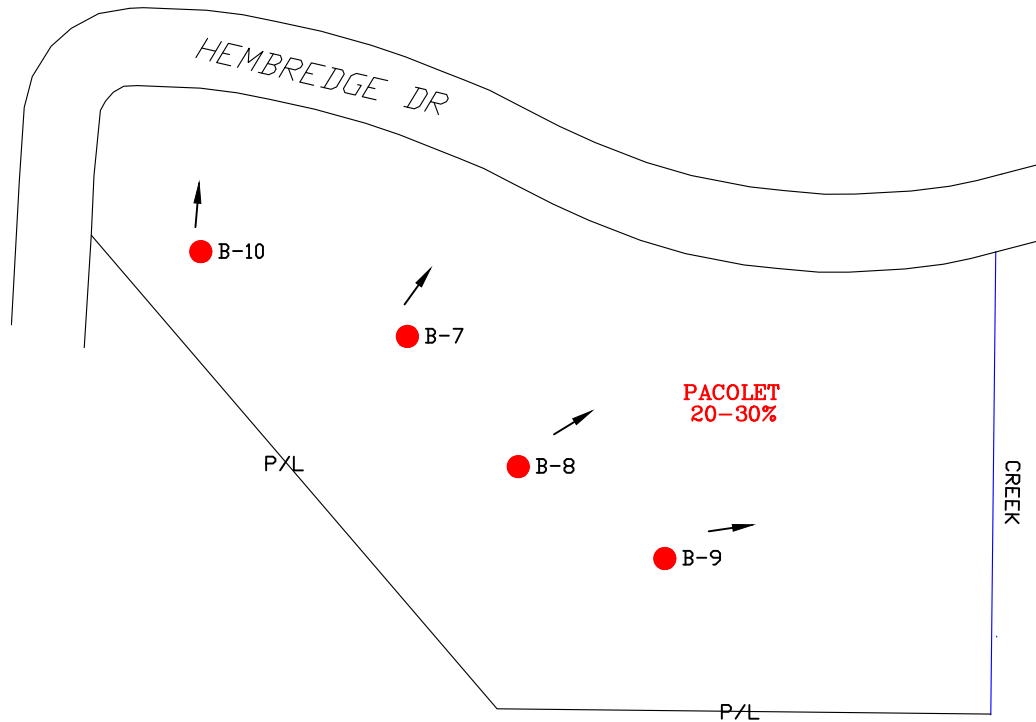

**GARLAND**

ENVIRONMENTAL & GEOLOGICAL SOLUTIONS, LLC.



2219 BRUSHY TOP ROAD  
ELLIJAY, GA 30540  
(706) 844-6753  
lwgardland@garlandgeological.com

LEVEL 3 SOIL SURVEY  
125 HEMBREDGE DRIVE  
CANTON, GA

SCALE 1" = 100'



LEGEND

-  B-1 = Boring Location
-  = Slope Direction
- PACOLET** = Soil Series
- 20-30%** = And % Slope



## LEVEL 3 SOIL REPORT

<b>COUNTY:</b> Cherokee	<b>DATE:</b> 10/10/2022
<b>OWNER:</b> Rebecca Eadie	
<b>SITE LOCATION ADDRESS:</b> 255 & 301 Hembredge Drive, Canton, GA	
<b>PHONE NUMBER:</b> (770) 826-7333	
<b>SCALE:</b> 1" = 100'	

### SOIL PROPERTIES

BORING NUMBER	SOIL SERIES	SLOPE	RESTRICTIVE /REFUSAL LAYER (inches)	DEPTH TO SEASONAL HIGH H <sub>2</sub> O TABLE (inches)	ABSORPTION RATE AT RECOMMENDED TRENCH DEPTH (min/inch)	RECOMMENDED TRENCH DEPTH (inches)	SUITABILITY CODE (Listed Below)
		<i>(Verified)</i>	<i>(Verified)</i>	<i>(Verified)</i>	<i>(Predicted)</i>	<i>(Verified)</i>	
B-1	Pacolet	10%	60	>60	45	30-36	A
B-2	Pacolet	12%	72	>72	45	30-42	A
B-3	Pacolet	15%	72	>72	45	30-42	A
B-4	Pacolet	10%	72	>72	45	30-42	A
B-5	Hard Labor II	10%	24	>24	--	--	H
B-6	Hard Labor II	10%	60	60	60	24	A

#### SUITABILITY CODE DESCRIPTIONS & GENERAL NOTES:

**SUITABILITY CODE A:** These soils are suitable for installation of on-site systems with proper system design, installation, and maintenance.

**SUITABILITY CODE H:** Rock or stony conditions were encountered which may make these areas unsuitable installation of a conventional on-site system. Small areas of soils with shallow bedrock may occur as inclusions in these map units. It may be necessary to perform more

Garland Environmental & Geological Solutions, LLC  
2219 Brushy Top Road, #6709, Ellijay, GA 30540  
(706) 844-6753, lwgarland@garlandgeological.com

intensive investigations or that the on-site system is installed prior to home construction to ensure bedrock limitations are not present on the site.

Miscellaneous Notes:

All borings are flagged in the field and labeled. This Soil Report has been composed in accordance with the standards and regulations set forth in the Georgia Department of Human Public Health Manual for On-Site Sewage Management Systems, June 2019. Garland Environmental & Geological Solutions, LLC does not issue permits, install, maintain or guarantee the performance of any on-site sewage management system. The County Health Department has the authority to permit on-site sewage management systems on this property and may have a different view of the soil conditions. The County Health Department has final jurisdiction over permitting and regulating on-site sewage management systems. This report does not address individual County zoning or building requirements.

Any alteration or additions to this report without the expressed, written consent and approval of GEGS, LLC will render this report null and void. Any grading or alteration to the site after the date on which the fieldwork was performed may change the nature and suitability of the site and may be cause for denial of permit.



This report was completed by Certified Soil Classifier: \_\_\_\_\_

Luke W. Garland, PG  
Georgia Professional Geologist #PG002251



## LEVEL 3 SOIL REPORT

<b>COUNTY:</b> Cherokee	<b>DATE:</b> 10/10/2022
<b>OWNER:</b> Rebecca Eadie	
<b>SITE LOCATION ADDRESS:</b> 125 Hembredge Drive, Canton, GA	
<b>PHONE NUMBER:</b> (770) 826-7333	
<b>SCALE:</b> 1" = 100'	

### SOIL PROPERTIES

BORING NUMBER	SOIL SERIES	SLOPE	RESTRICTIVE /REFUSAL LAYER (inches)	DEPTH TO SEASONAL HIGH H <sub>2</sub> O TABLE (inches)	ABSORPTION RATE AT RECOMMENDED TRENCH DEPTH (min/inch)	RECOMMENDED TRENCH DEPTH (inches)	SUITABILITY CODE (Listed Below)
		<i>(Verified)</i>	<i>(Verified)</i>	<i>(Verified)</i>	<i>(Predicted)</i>	<i>(Verified)</i>	
B-7	Pacolet	30%	72	>72	45	30-42	A
B-8	Pacolet	25%	72	>72	45	30-42	A
B-9	Pacolet	22%	72	>72	45	30-42	A
B-10	Pacolet	25%	72	>72	45	30-42	A

#### SUITABILITY CODE DESCRIPTIONS & GENERAL NOTES:

**SUITABILITY CODE A:** These soils are suitable for installation of on-site systems with proper system design, installation, and maintenance.

Miscellaneous Notes:

All borings are flagged in the field and labeled. This Soil Report has been composed in accordance with the standards and regulations set forth in the Georgia Department of Human Public Health Manual for On-Site Sewage Management Systems, June 2019. Garland Environmental & Geological Solutions, LLC does not issue permits, install, maintain or guarantee the performance of any on-site sewage management system. The County Health Department has the authority to permit on-site sewage management systems on this property and may have a different view of the soil conditions. The County Health Department has final jurisdiction over permitting and regulating on-site sewage management systems. This report does not address individual County zoning or building requirements.

Any alteration or additions to this report without the expressed, written consent and approval of GEGS, LLC will render this report null and void. Any grading or alteration to the site after the date on which the fieldwork was performed may change the nature and suitability of the site and may be cause for denial of permit.



This report was completed by Certified Soil Classifier: \_\_\_\_\_

Luke W. Garland, PG  
Georgia Professional Geologist #PG002251



## LEVEL 3 SOIL REPORT

<b>COUNTY:</b> Cherokee	<b>DATE:</b> 10/10/2022
<b>OWNER:</b> Rebecca Eadie	
<b>SITE LOCATION ADDRESS:</b> 125 Hembredge Drive, Canton, GA	
<b>PHONE NUMBER:</b> (770) 826-7333	
<b>SCALE:</b> 1" = 100'	

### SOIL PROPERTIES

BORING NUMBER	SOIL SERIES	SLOPE	RESTRICTIVE /REFUSAL LAYER (inches)	DEPTH TO SEASONAL HIGH H <sub>2</sub> O TABLE (inches)	ABSORPTION RATE AT RECOMMENDED TRENCH DEPTH (min/inch)	RECOMMENDED TRENCH DEPTH (inches)	SUITABILITY CODE (Listed Below)
		<i>(Verified)</i>	<i>(Verified)</i>	<i>(Verified)</i>	<i>(Predicted)</i>	<i>(Verified)</i>	
B-7	Pacolet	30%	72	>72	45	30-42	A
B-8	Pacolet	25%	72	>72	45	30-42	A
B-9	Pacolet	22%	72	>72	45	30-42	A
B-10	Pacolet	25%	72	>72	45	30-42	A

#### SUITABILITY CODE DESCRIPTIONS & GENERAL NOTES:

**SUITABILITY CODE A:** These soils are suitable for installation of on-site systems with proper system design, installation, and maintenance.

Miscellaneous Notes:

All borings are flagged in the field and labeled. This Soil Report has been composed in accordance with the standards and regulations set forth in the Georgia Department of Human Public Health Manual for On-Site Sewage Management Systems, June 2019. Garland Environmental & Geological Solutions, LLC does not issue permits, install, maintain or guarantee the performance of any on-site sewage management system. The County Health Department has the authority to permit on-site sewage management systems on this property and may have a different view of the soil conditions. The County Health Department has final jurisdiction over permitting and regulating on-site sewage management systems. This report does not address individual County zoning or building requirements.

Any alteration or additions to this report without the expressed, written consent and approval of GEGS, LLC will render this report null and void. Any grading or alteration to the site after the date on which the fieldwork was performed may change the nature and suitability of the site and may be cause for denial of permit.



This report was completed by Certified Soil Classifier: \_\_\_\_\_

Luke W. Garland, PG  
Georgia Professional Geologist #PG002251